

ProMax®



ENHANCED HEATING ELEMENTS

- Dual 4500 watt elements for fast recovery and reliable operation.*
- Incoloy stainless steel lower element lasts longer than a standard copper element.

DYNACLEAN™ DIFFUSER DIP TUBE

- Helps reduce lime and sediment buildup and maximizes hot water output. Made from long-lasting PEX cross-linked polymer.

HIGH ENERGY FACTORS

- Eco-friendly non-CFC foam insulation, heat traps and other features combine to yield a higher Energy Factor that maximizes savings on operating costs.

COREGARD™ ANODE ROD

- Our anode rods have a stainless steel core that extends the life of the anode rod allowing superior tank protection far longer than standard anode rods.

BLUE DIAMOND® GLASS COATING

- Provides superior corrosion resistance compared to industry standard glass lining.

ENHANCED-FLOW BRASS DRAIN VALVE

- Our residential water heaters have a solid brass, tamper resistant, enhanced-flow, ball type, drain valve.
- Uses a standard female hose fitting that allows for fast and easy draining during maintenance.
- Designed for easy operation, this valve includes an integral screwdriver slot that features a ¼ turn (open/close) radius, which not only permits full straight-through water flow but also a quick and positive shut off.

*Model ENL-20 has a single element.

CODE COMPLIANCE

- Meets UBC and ICC National Codes and listed with CEC.
- Complies with the Federal Energy Conservation Standards effective April 16, 2015, in accordance with the Energy Policy and Conservation Act (EPCA), as amended.

APPROVED FOR MANUFACTURED HOUSING

- All residential electric water heaters are compliant with HUD Standards for mobile homes/manufactured housing.

CERTIFIED TO UL 174 FOR HOUSEHOLD ELECTRIC WATER HEATERS

CSA CERTIFIED AND ASME RATED T&P RELIEF VALVE

DESIGN-LISTED BY UNDERWRITERS LABORATORIES

- Certified at 300 psi test pressure and 150 psi working pressure.
- Listed according to UL 174 standards governing storage tank-type electric water heaters.

6-YEAR LIMITED TANK AND PARTS WARRANTY

- For complete information, consult written warranty or go to hotwater.com.



Model Number	Gallon Capacity	First Hour Rating Gallon	Energy Factor	Recovery @ 90°F Rise Gallon Per Hour	Element Wattage 240V		Dimensions in Inches			Approx. Shipping Weight (lbs)
					Standard	Maximum	A	B	C	
Tall Models										
ENT-30†	30	47	0.95	21	4500	6000	46-1/2	39-1/2	19	95
ENT-40†	40	51	0.95	21	4500	6000	60-1/4	53-1/4	20	118
ENTB-50*	50	70	0.95	21	4500	6000	60-1/4	51-1/4	21	131
ENT-50†	50	71	0.95	21	4500	6000	60-1/2	51-1/4	22	134
ENT-55†	55	76	0.94	21	4500	6000	56-1/2	48-1/2	24	145
Short Models										
ENSB-30*	30	48	0.95	21	4500	6000	39	30-1/2	20	95
ENS-30†	30	49	0.95	21	4500	6000	39-3/4	30-1/2	22	94
ENS-40†	40	55	0.95	21	4500	6000	50	40-3/4	20-1/2	109
ENS-50†	50	62	0.95	21	4500	6000	49-3/4	40-3/8	23	161
Lowboy Top Connect Models										
ENL-20	19.5	N/A	N/A	21	4500	6000	30	21-1/4	20	65
ENLB-30*	28	40	0.95	21	4500	6000	30	21-3/4	22	96
ENL-30†	28	43	0.95	21	4500	6000	31-1/4	21-3/4	24	115
ENLB-40*	38	46	0.95	21	4500	6000	31-3/4	24	24	118
ENL-40†+	38	44	0.95	21	4500	6000	33-1/2	24	26	118
ENLB-50*†	48	57	0.95	21	4500	6000	34	25	26-1/2	172

Male 3/4" water connections on 8" center.

*Models ship with supplied insulation blanket.

†For 10-year tank and 6-year parts warranty, change "E" to "P" in the model number (example: ENT-30 becomes PNT-30).

+ Top T&P option not available on this model.

ENL-20 is a single element configuration only

Optional T&P location #2 is used on the ENT-50, ENTB50, ENT-55, ENS-40 and ENS-50

Top T&P is not available on the 10 year model PNLB-50.

Dimensions and specifications subject to change without notice in accordance with our policy of continuous product improvement.

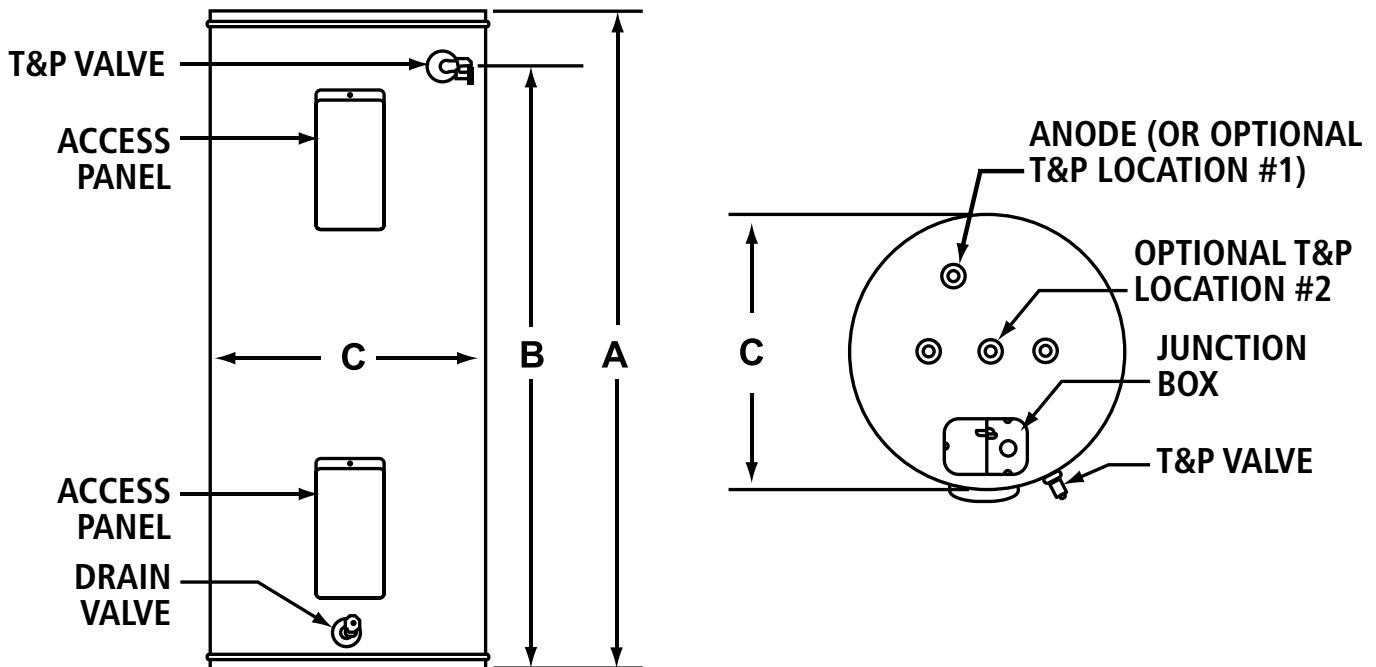

For technical information call 800-527-1953. A. O. Smith Corporation reserves the right to make product changes or improvements without prior notice.